



**28 Homerise House Hyde Street, Winchester**  
Winchester

£72,000  
**DYBLES**





## 28 Homerise House Hyde Street

Winchester, Winchester

Tenure: Leasehold (exp:25/03/2080)

Council Tax Band: A (2024/2025 £1,433.65 PA)

Utilities: Mains connected to Electric, Water and Waste

EPC Rating: C

Ground rent: £927.90

Service charge: £3,936.90

Council Tax band: A

Tenure: Leasehold

# Homerise House, Hyde Street, Winchester, SO23

Approximate Area = 489 sq ft / 45.4 sq m

For identification only - Not to scale

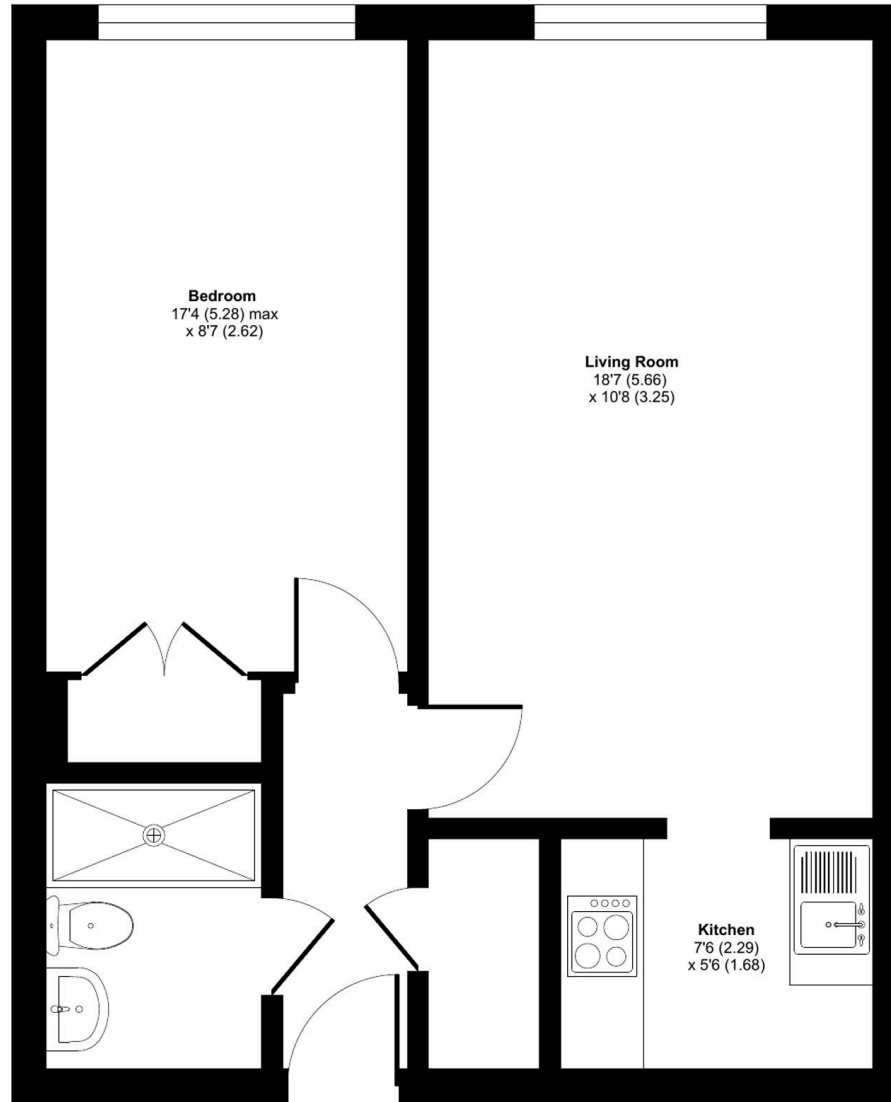

## SECOND FLOOR



Floor plan produced in accordance with RICS Property Measurement 2nd Edition, Incorporating International Property Measurement Standards (IPMS2 Residential). © nchecom 2024. Produced for Dyles. REF: 1226657



## Dybles

Unit 4, Black Swan Buildings Southgate Street - SO23 9DT

01962 866644 • [winchester@dybles.com](mailto:winchester@dybles.com) • [www.dybles.com](http://www.dybles.com)