



1 Princes Place, Winchester
Winchester

£380,000
DYBLES





1 Princes Place

Winchester, Winchester

Welcome to this charming three/four bedroom semi-detached home, nestled in the desirable neighborhood of Stanmore. This versatile residence offers a range of possibilities, making it an ideal choice for a family or an astute investor. Currently occupied by students for the academic year, this property is a unique opportunity.

[As](#) you step into the home, you'll be greeted by an inviting entrance hall, thoughtfully designed to provide ample storage space for your everyday needs. The ground floor boasts a spacious lounge area, perfect for relaxing and entertaining. Additionally, there's an extra reception room, currently being used as a fourth bedroom, providing flexibility to cater to your specific requirements. Completing the ground floor is a well-appointed kitchen with generous storage options and a convenient downstairs W/C.

Ascending to the first floor, you'll discover three generously sized bedrooms, each offering comfort and tranquility. The final internal feature is the family bathroom as well as a separate W/C.

Externally, this property stands out with its off-road parking, ensuring that you and your guests have hassle-free access. The well-sized garden and side return offer fantastic scope for extension (STP) or those who enjoy outdoor relaxation. One of the key advantages of this property is the absence of a forward chain, making the transaction process smooth and efficient. Whether you're seeking a family home or an investment opportunity, this residence caters to both needs.

Contact us today to arrange a viewing and explore the endless possibilities this home has to offer.

Council Tax band: C

Tenure: Freehold

Princes Place, Winchester, SO22

Approximate Area = 1023 sq ft / 95 sq m

Limited Use Area(s) = 12 sq ft / 1.1 sq m

Total = 1035 sq ft / 96.1 sq m



For identification only - Not to scale

Denotes restricted head height

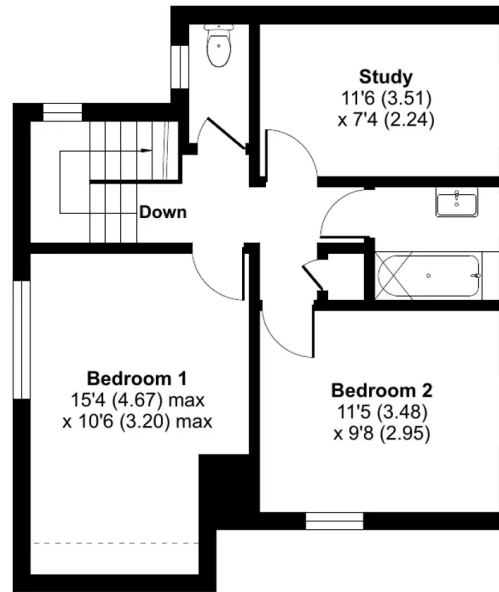

FIRST FLOOR

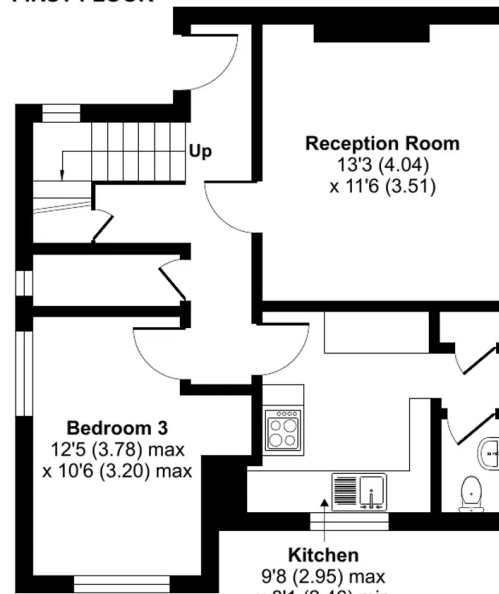

GROUND FLOOR



Floor plan produced in accordance with RICS Property Measurement Standards incorporating International Property Measurement Standards (IPMS2 Residential). © nlcocom 2023. Produced for Dylbes. REF: 1047991



Dybles

Unit 4, Black Swan Buildings Southgate Street - SO23 9DT

01962 866644 • winchester@dybles.com • www.dybles.com