



**5 Skintle Green, Colden Common**  
Winchester

Offers Over **£440,000**  
**DYBLES**









## 5 Skintle Green

Colden Common, Winchester

Dybles are delighted to present to the market this stunning family home. Located in Colden Common, the home offers a wide range of amenities which include (but are not limited to) schools, shops, parks, transport links and all with being a short distance from Winchester and its thriving high street.

Upon entry you're greeted by a useful entrance porch, ideal for storage. Flowing from this is a hallway which is home to a downstairs shower room that's tastefully presented. Following from this is the real social hub of the home, a gorgeous open plan lounge/kitchen/dining area. This wrap around space offers such a layer of versatility to be sculpted into whatever is required by a prospective buyer/family. The high finish throughout this space supplies a fantastic level of ease. This area also comes equipped with a log burner. The kitchen offers integrated units and a breakfast bar which adds a further entertaining factor to the home when coupled with the more formal dining space.

The first floor will not disappoint, with three bedrooms and a family bathroom. All three bedrooms offer comfortable space for a double bed as well as the two largest having built in storage. Similarly with the ground floor, the entirety of the first floor is presented to a high standard. This is no exception with the family bathroom which consists of a bath, basin and toilet.

Externally, the home further flourishes with a large front garden, adding to the curb appeal and

# Colden Common, Winchester, SO21

Approximate Area = 1229 sq ft / 114.2 sq m (includes garage)

For identification only - Not to scale

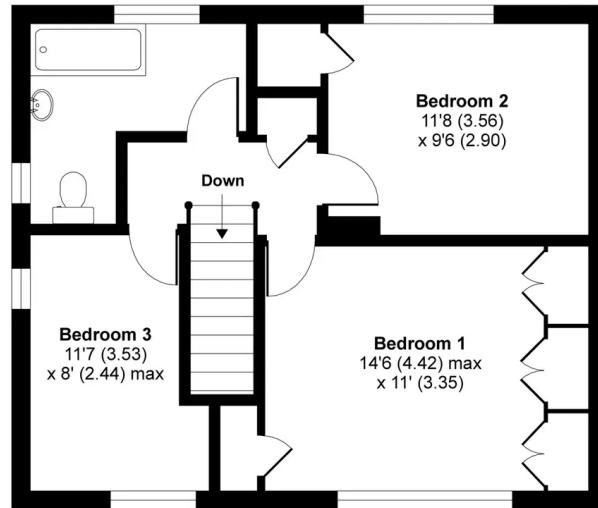

FIRST FLOOR

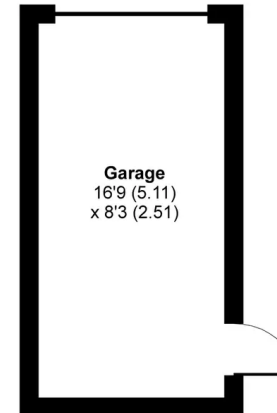
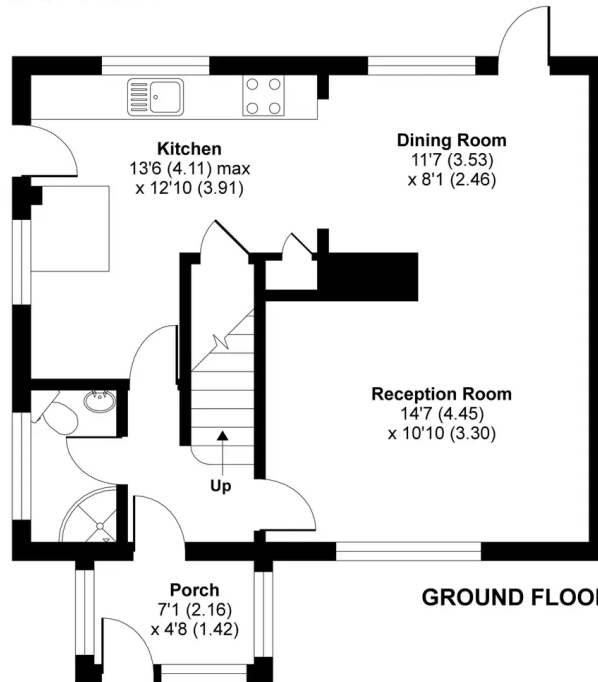

GROUND FLOOR







## Dybles

Unit 4, Black Swan Buildings Southgate Street - SO23 9DT

01962 866644 • [winchester@dybles.com](mailto:winchester@dybles.com) • [www.dybles.com](http://www.dybles.com)